



ASSEMBLY INSTRUCTIONS

WORMY WONDERLAND BIRDHOUSE

HINTS & TIPS

Always use a good quality wood glue. You may find low tack masking tape useful to hold things together while drying. Make sure you wipe away any glue oozes immediately with a damp cloth.



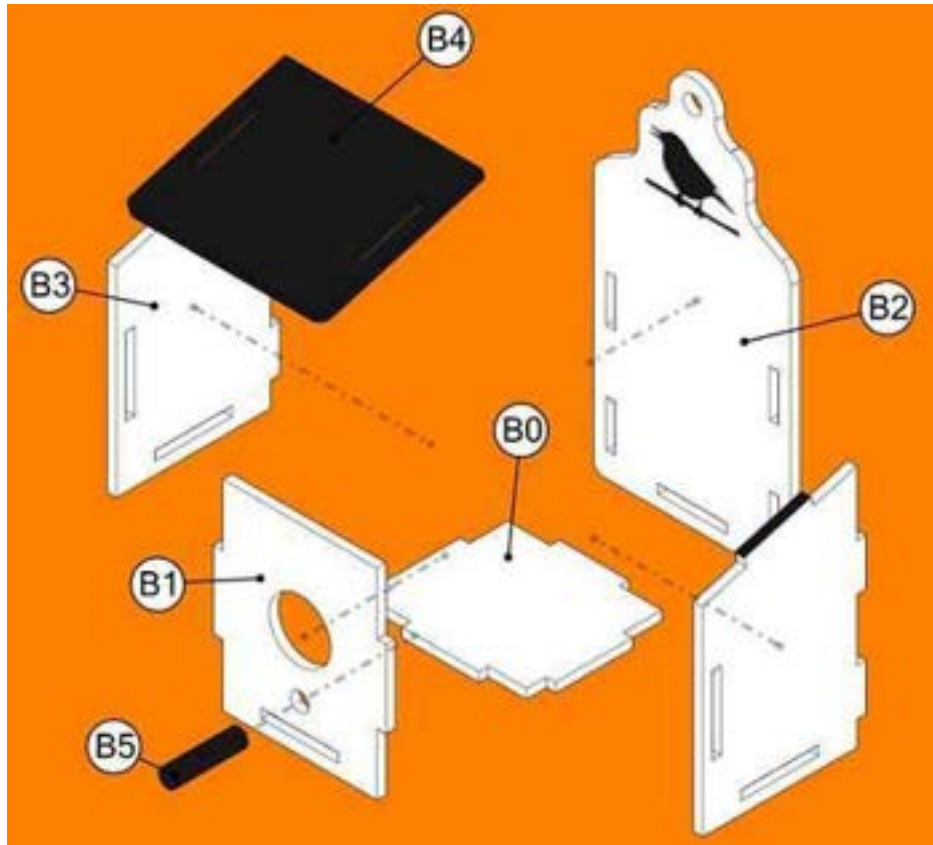

- Your kit will arrive as flat pack pieces – lay them out before you begin with good sides out.
- Glue and slot together the front piece (B1), back piece (B2), and the 2 sides (B3) to the base piece (B0) – this forms the box of the birdhouse.
- You can glue on the bird embellishment as shown, or to another part of the birdhouse or keep it for another project!

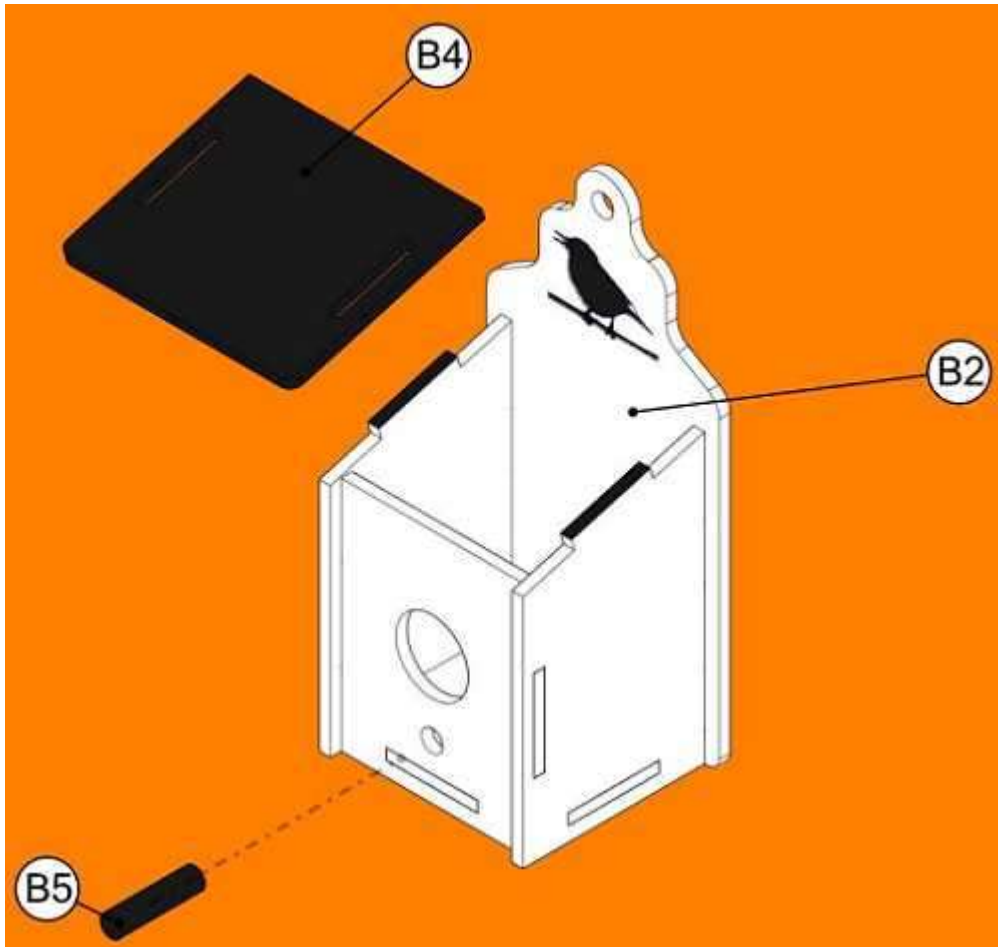

- Glue in the dowel for the perch.
- The kit also includes a ring shape (not shown) that you can glue onto the birdhouse entrance.
- The lid can be glued permanently in place or left unglued so you can remove it – ideal if you want to create a miniature scene within or even use the birdhouse as a storage box!



- The finished piece with a basic paint job!
- For best results, seal the finished piece with a suitable acrylic sealer – DecoArt Mod Podge in matte is highly recommended. This provides a uniform surface on which to paint.
- You can also use Mod Podge as a glue to cover all or part of the birdhouse with pretty papers – use the unassembled kit pieces as a pattern.

We hope you've enjoyed putting your kit together.